

NOTE A
 W100-DS-A: 191300 Free Chlorine, 0-20 ppm
 W100-DS-B: 191280 ClO₂, 0-20 ppm
 W100-DS-C: 191320 Ozone, 0-20 ppm
 W100-DS-D: 191338 Peracetic acid, 0-2000 ppm
 W100-DS-E: 191445 Extended pH Range Chlorine, 0-20 ppm
 W100-DS-F: 104165 Total Chlorine, 0-20 ppm
 W100-DS-G: 191539 Hydrogen Peroxide, 0-2000 ppm
 Others available, contact factory

* Use '-20\'' for 20 ft. cables

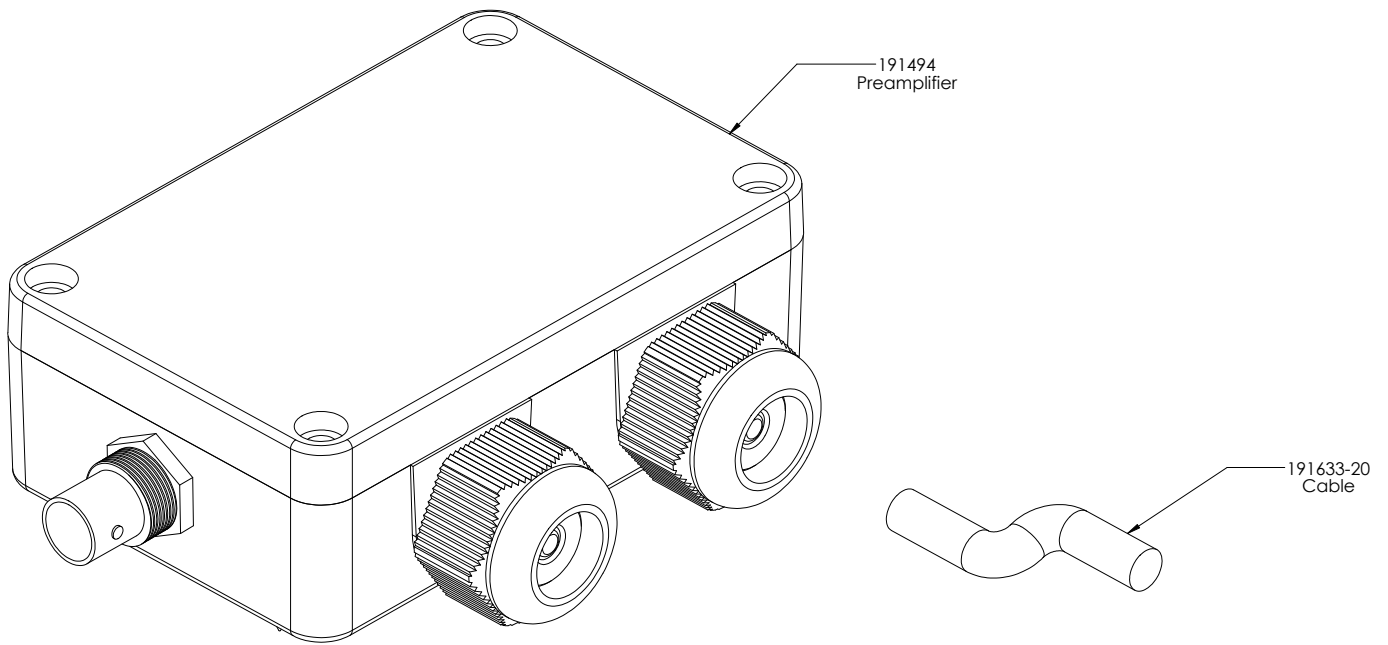

WPHPW Sensor Option A