

WCT Sensor Option PAMNN and PBMNN

PAMNN: Graphite contacting conductivity + Flow Switch manifold on panel + Little Dipper

PBMNN: 316SS contacting conductivity + Flow Switch manifold on panel + Little Dipper

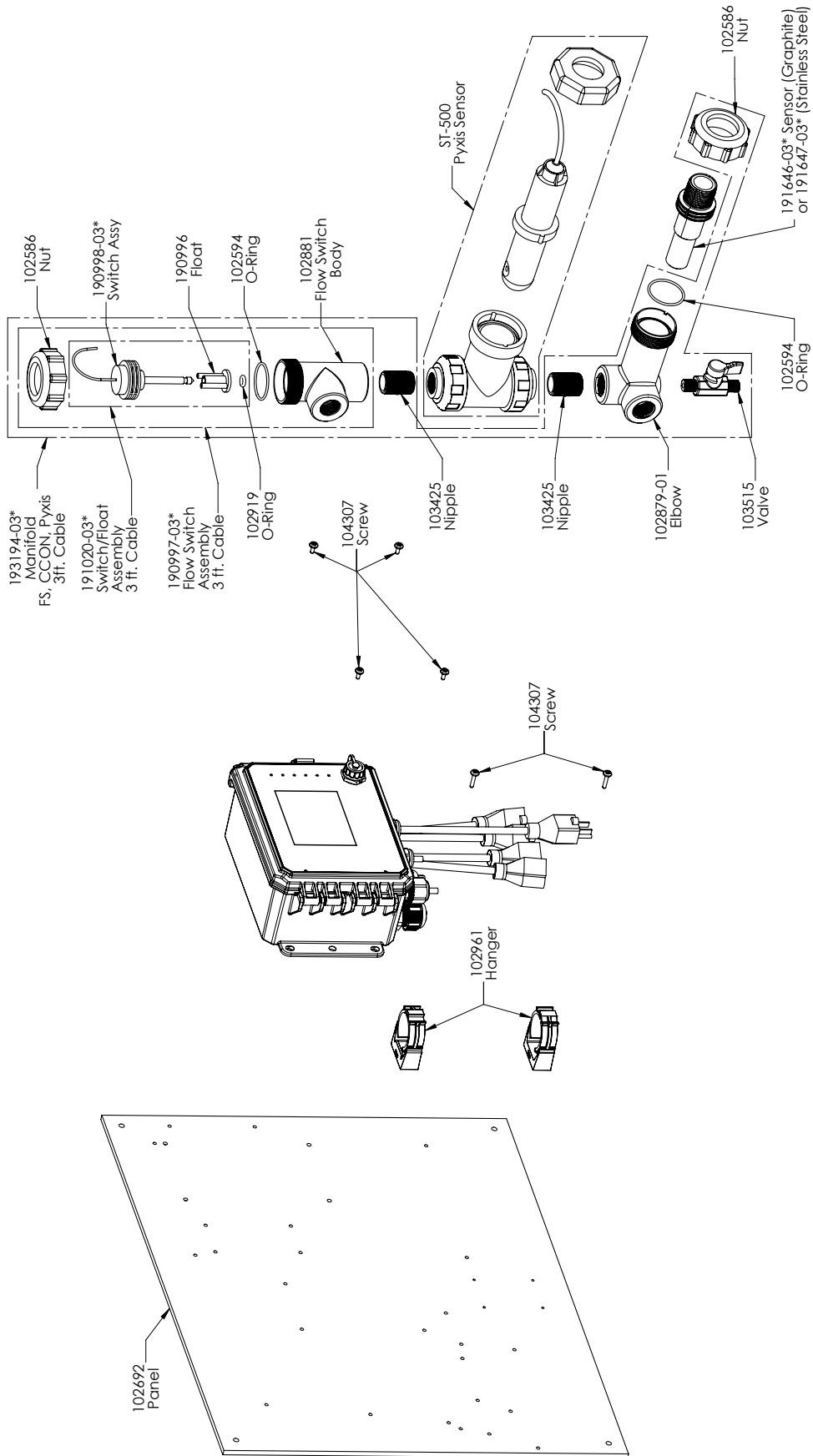

WCT Sensor Option PAPNN and PBPNN

PAPNN: Graphite contacting conductivity + Flow Switch manifold on panel + Pyxis
 PBPNN: 316SS contacting conductivity + Flow Switch manifold on panel + Pyxis

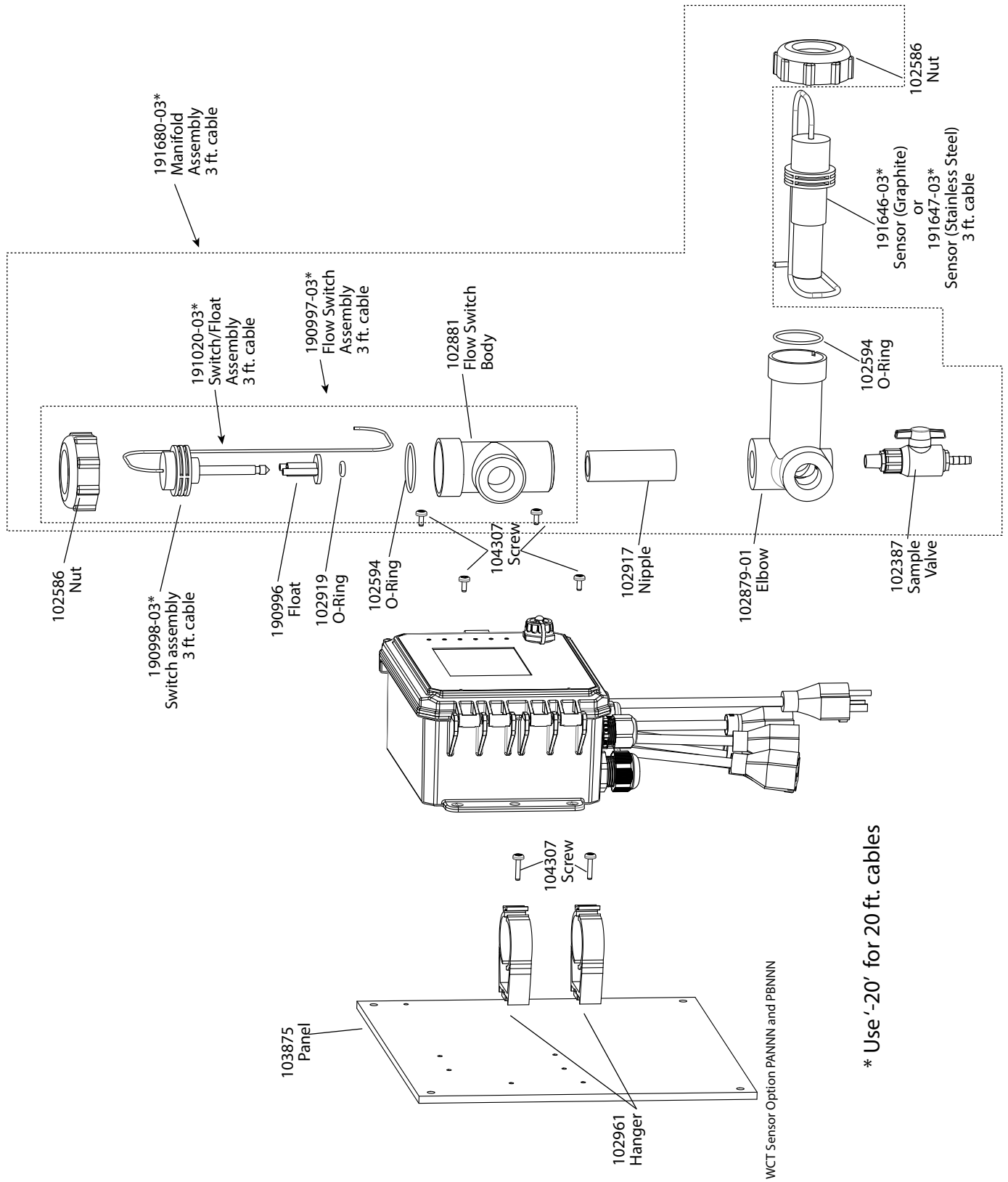

WCT Sensor Option PANNN and PBNNN

PANNN: Graphite contacting conductivity + Flow Switch manifold on panel

PBNNN: 316SS contacting conductivity + Flow Switch manifold on panel

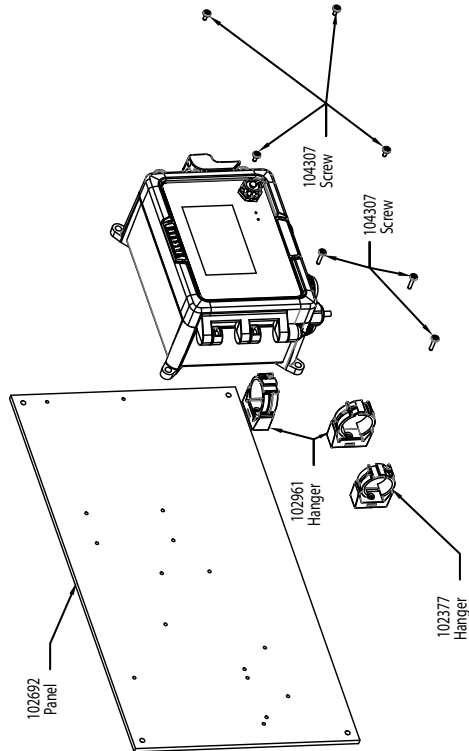
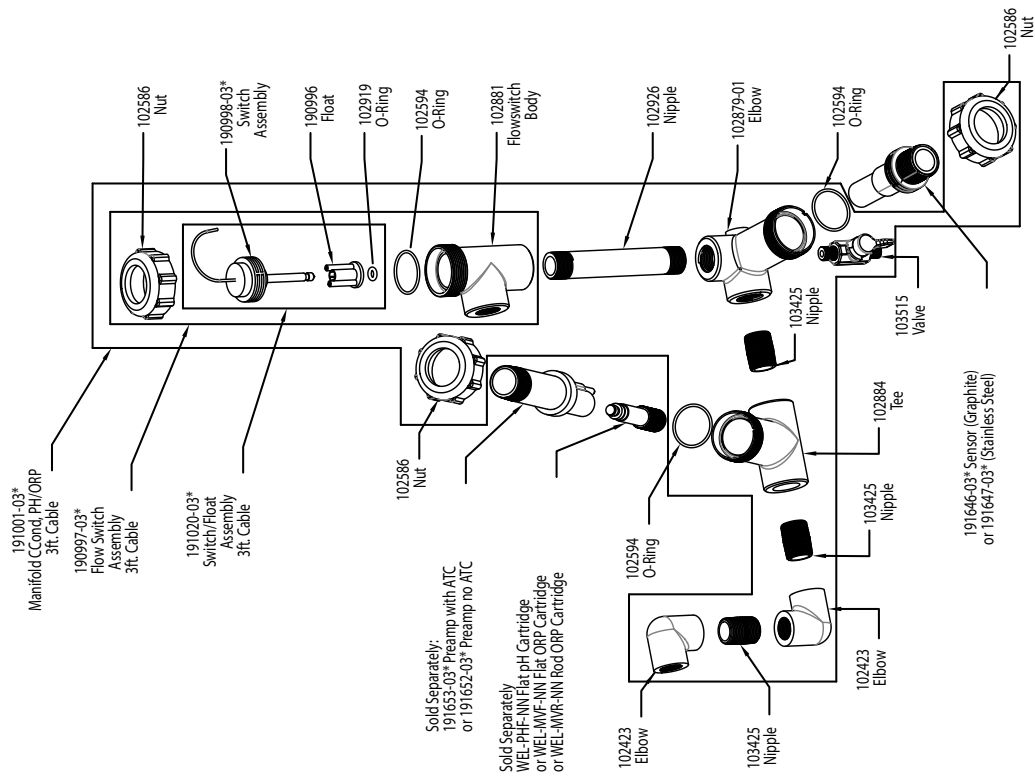

WCT Sensor Option PAFNN, PAHNN, PAINN, PBFNN, PBHNN, PBINN

- PAFNN: Graphite contacting conductivity + Flow Switch manifold on panel + WEL-PHF no ATC
- PAHNN: + WEL-MVR no ATC
- PAINN: +WEL-MVF no ATC
- PBFNN: 316SS contacting conductivity + Flow Switch manifold on panel + WEL-PHF no ATC
- PBHNN: + WEL-MVR no ATC
- PBINN: + WEL-MVF no ATC

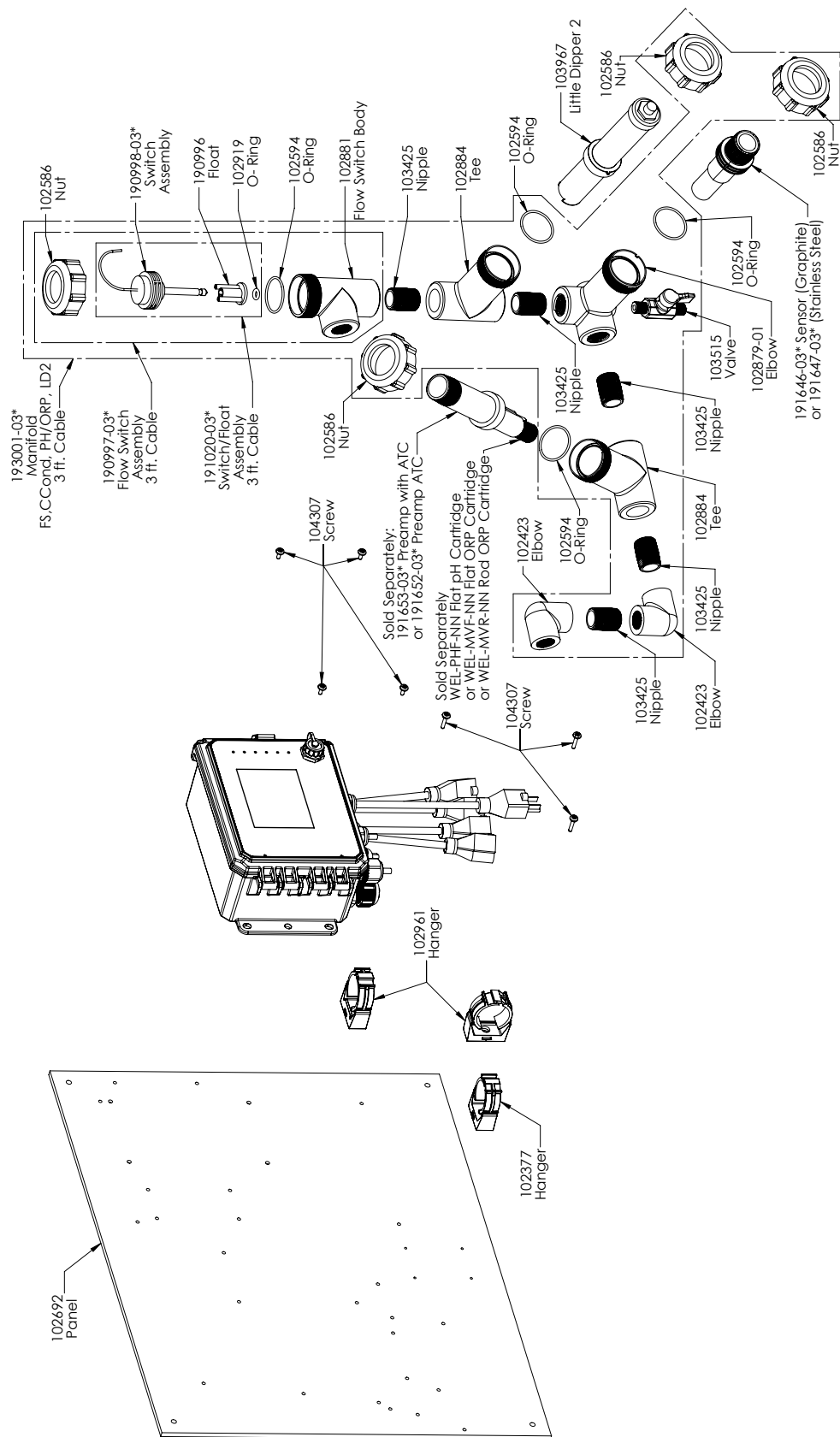

WCT Sensor Option PAFMN, PAHMN, PAIMN, PBFMN, PBHMN, PBIMN

- PAFMN: Graphite contacting conductivity + Flow Switch manifold on panel + WEL-PHF no ATC + Little Dipper
- PAHMN: + WEL-MVR no ATC + Little Dipper
- PAIMN: + WEL-MVF no ATC + Little Dipper
- PBFMN: 316SS contacting conductivity + Flow Switch manifold on panel + WEL-PHF no ATC + Little Dipper
- PBHMN: + WEL-MVR no ATC + Little Dipper
- PBIMN: + WEL-MVF no ATC + Little Dipper

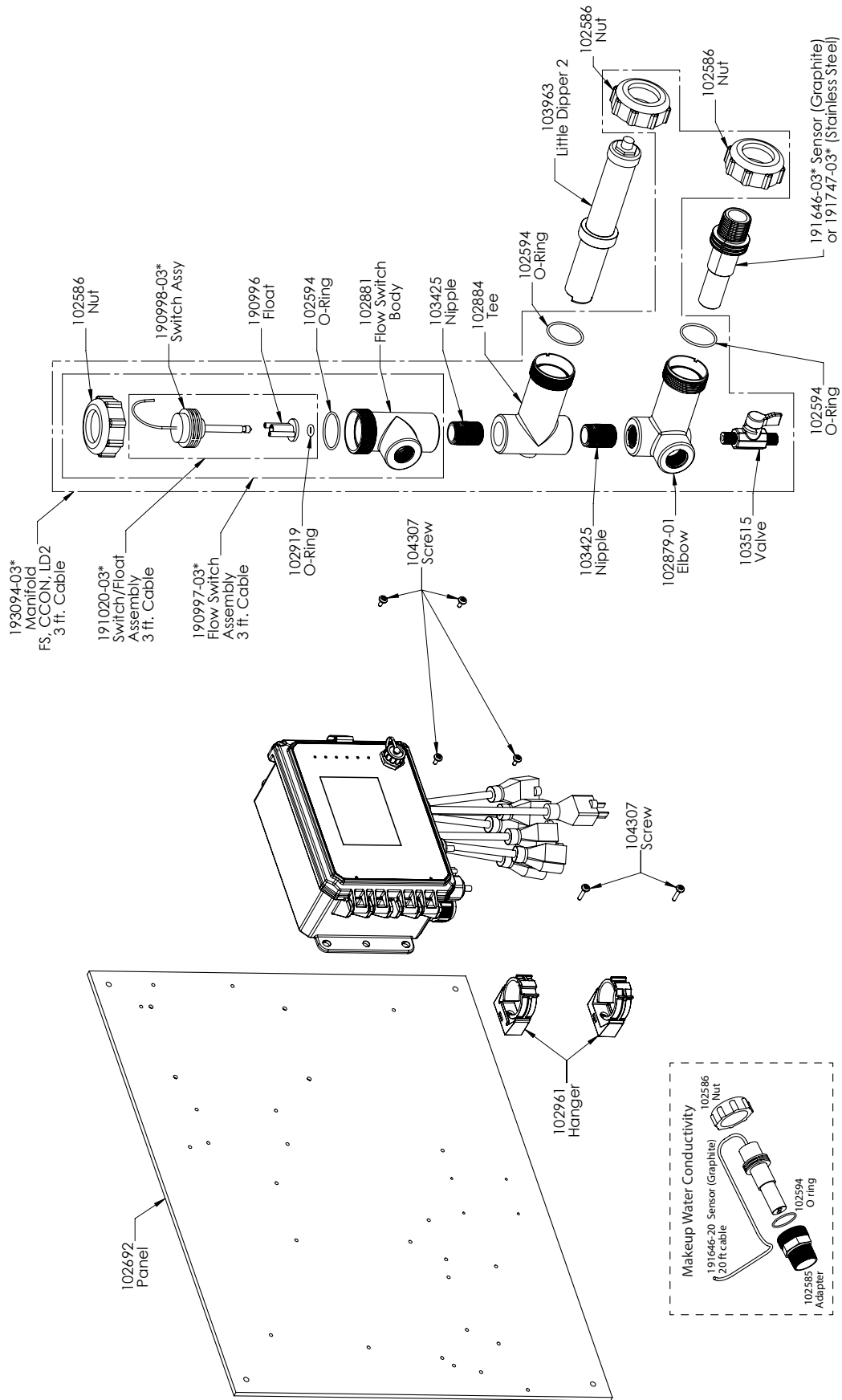

WCT Sensor Option PAEMN

Graphite contacting conductivity + LD + Flow Switch manifold on panel with Makeup graphite conductivity with threaded adapter

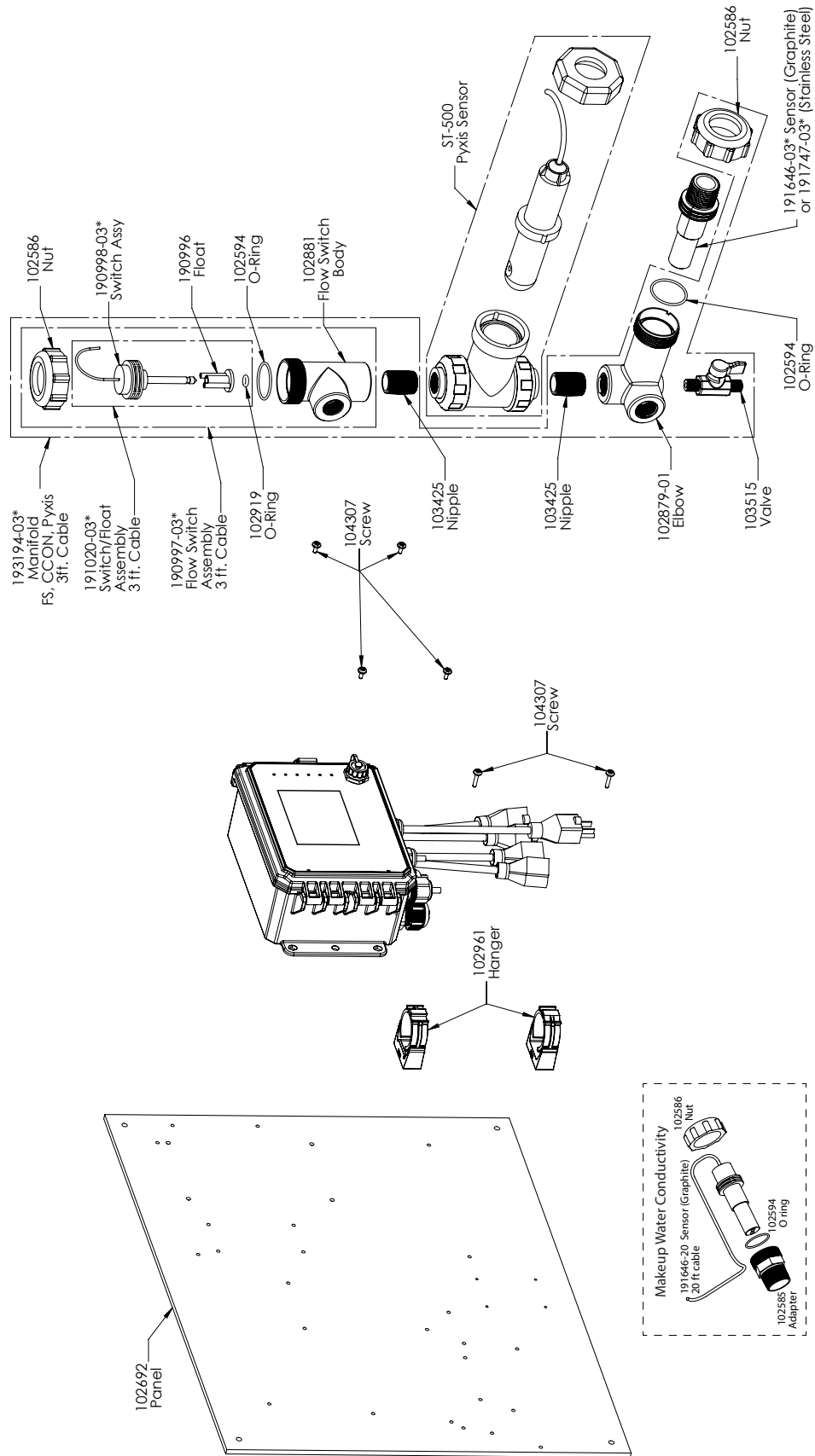

WCT Sensor Option PAEPN

Graphite contacting conductivity + Pyxis + Flow Switch manifold on panel with
 Makeup graphite conductivity with threaded adapter

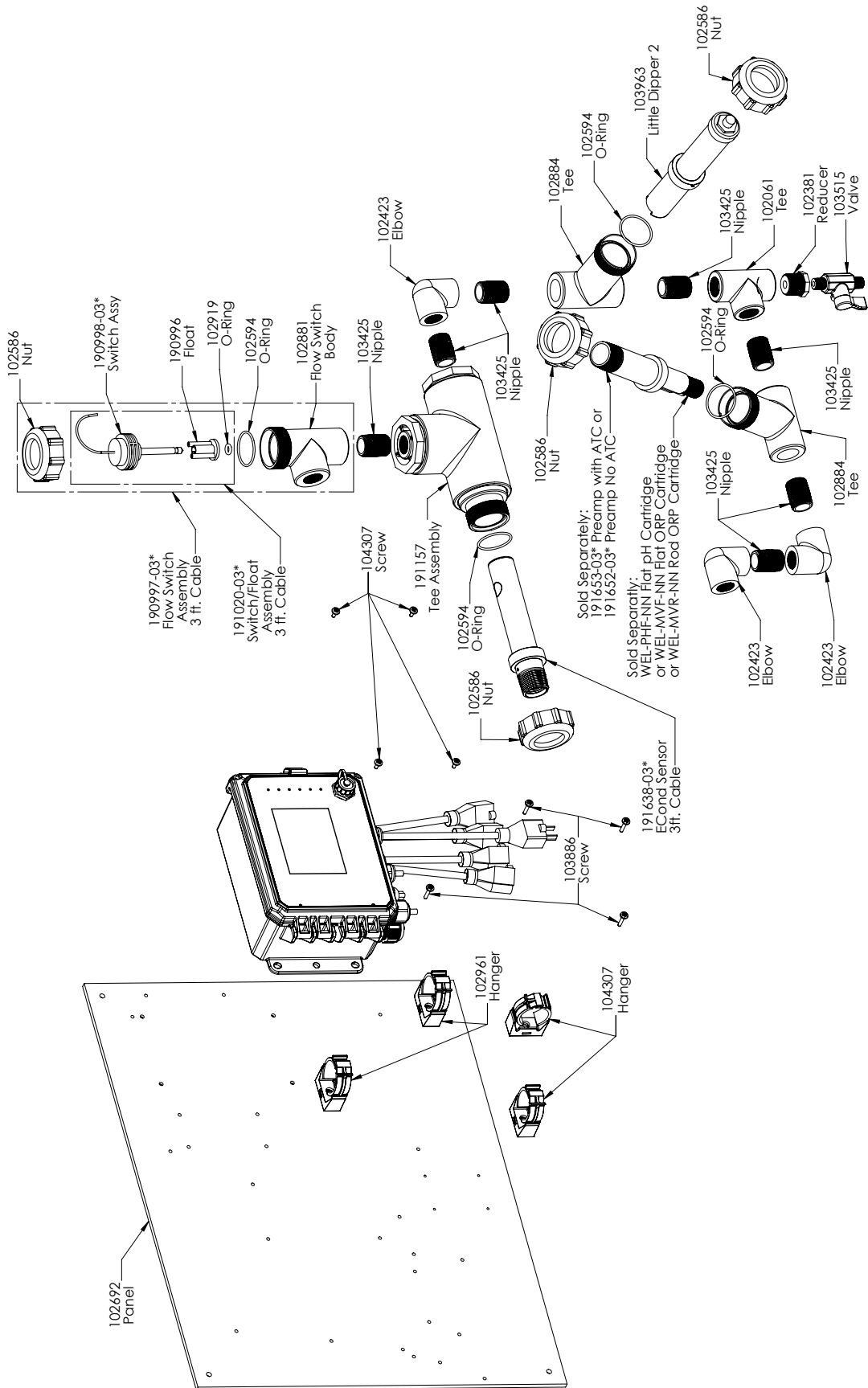

WCT Sensor Option PCFMN, PCHMN, PCIMN

PCFMN: Electrodeless conductivity + Flow Switch manifold on panel + WEL-PHF no ATC + LD
 PCHMN: + WEL-MVR no ATC + LD
 PCIMN: + WEL-MVF no ATC + LD

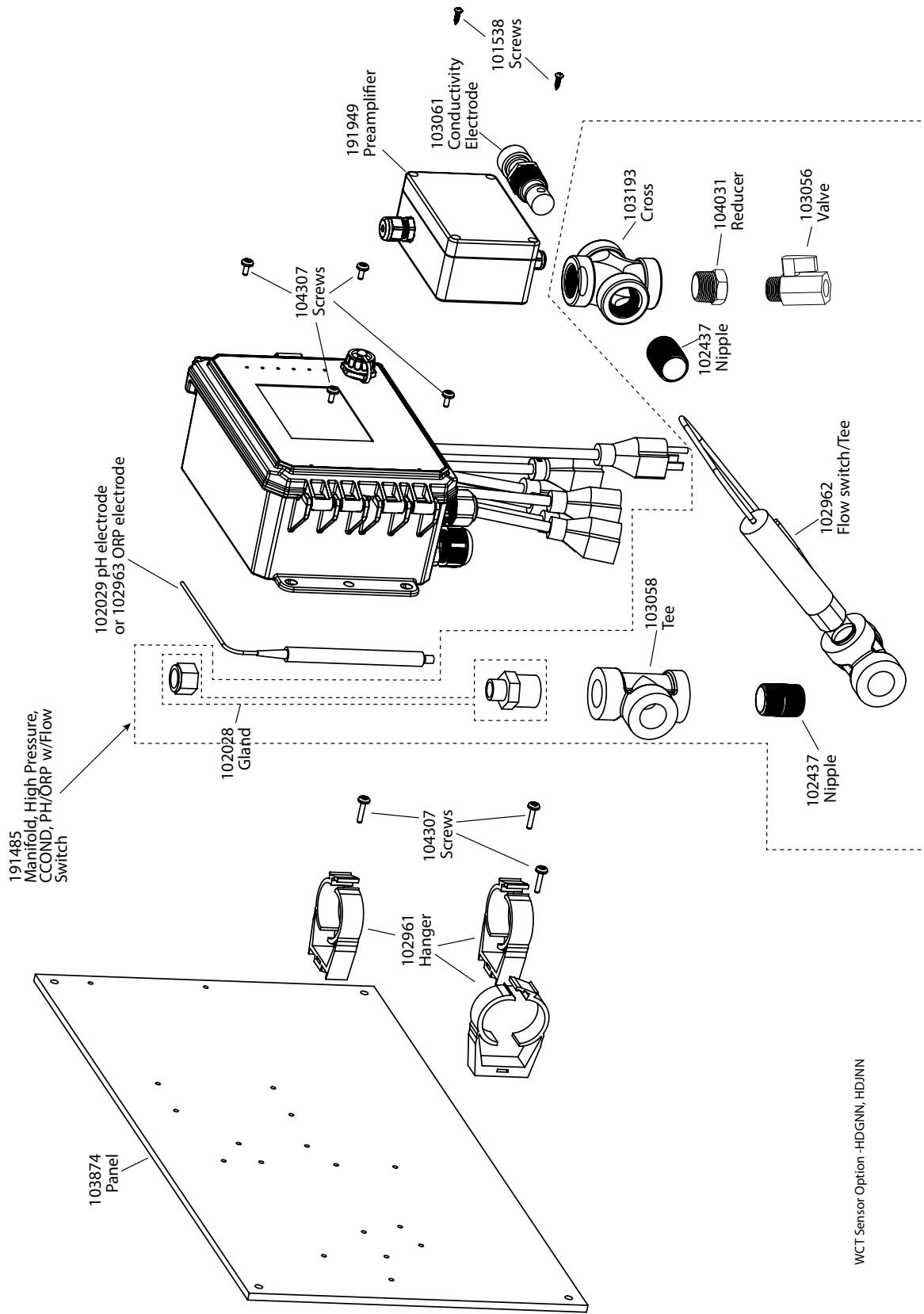

WCT Sensor Option - HDGNN, HDJNN

WCT Sensor Option HDGNN, HDJNN

HDGNN: High pressure contacting conductivity + Flow Switch manifold on panel + pH & 191949
 HDJNN: High pressure contacting conductivity + Flow Switch manifold on panel + ORP & 191949

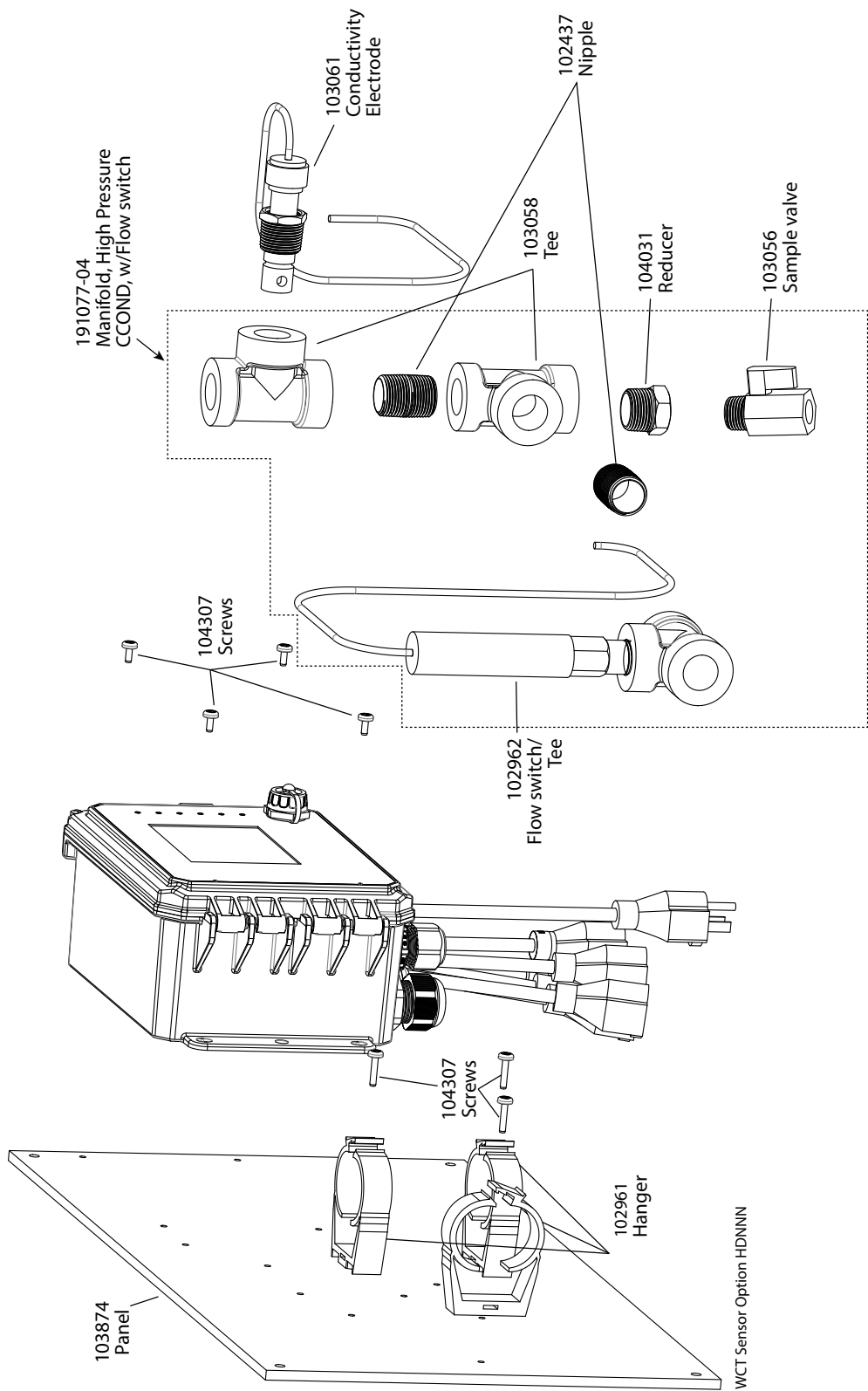

WCT Sensor Option HDNNN

HDNNN: High pressure contacting conductivity + Flow Switch manifold on panel

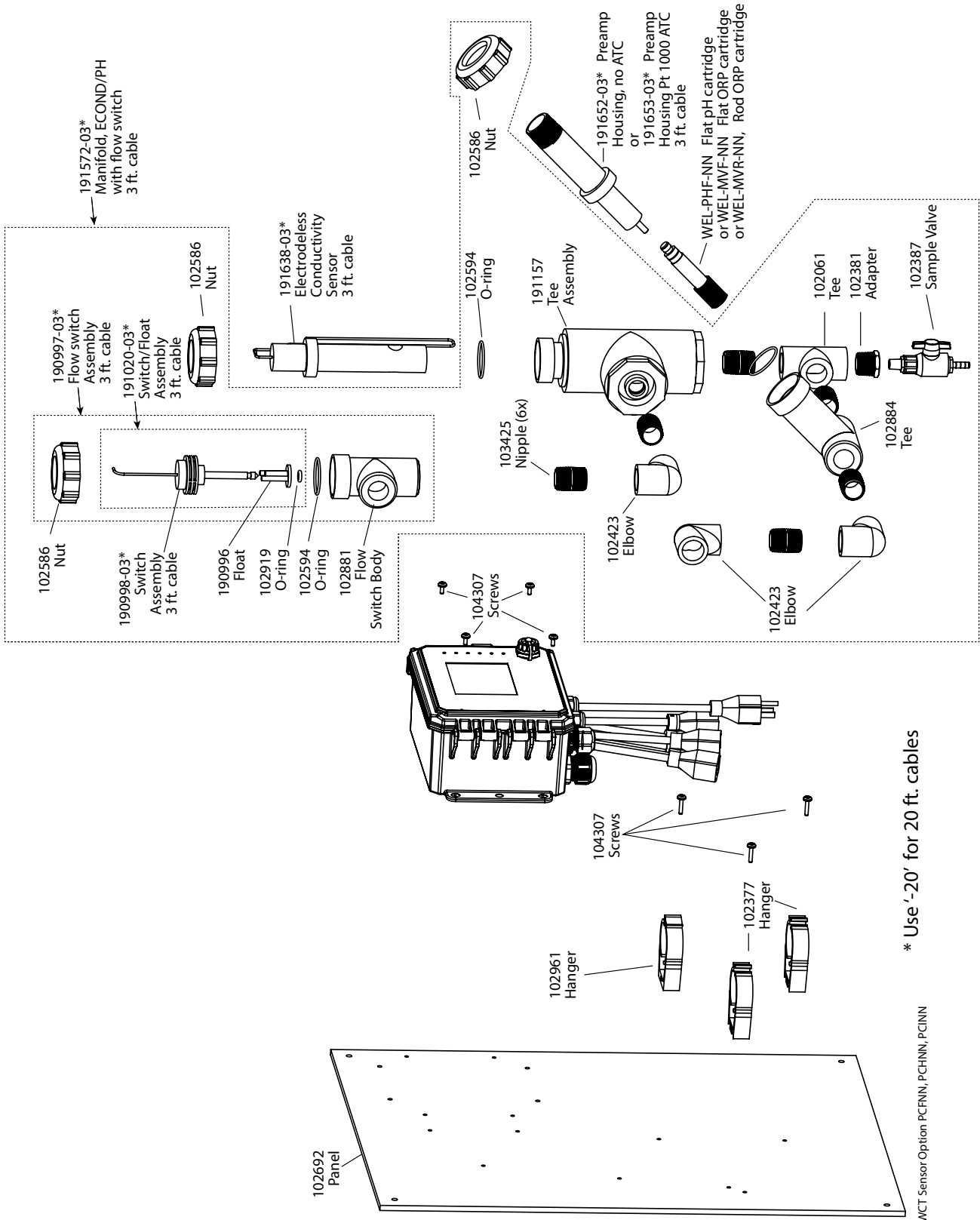

* Use '-20' for 20 ft. cables

WCT Sensor Option PCFNN, PCHNN, PCINN

WCT Sensor Option PCFNN, PCHNN, PCINN

- PCFNN: Electrodeless conductivity + Flow Switch manifold on panel + WEL-PHF no ATC
- PCHNN: + WEL-MVR no ATC
- PCINN: + WEL-MVF no ATC

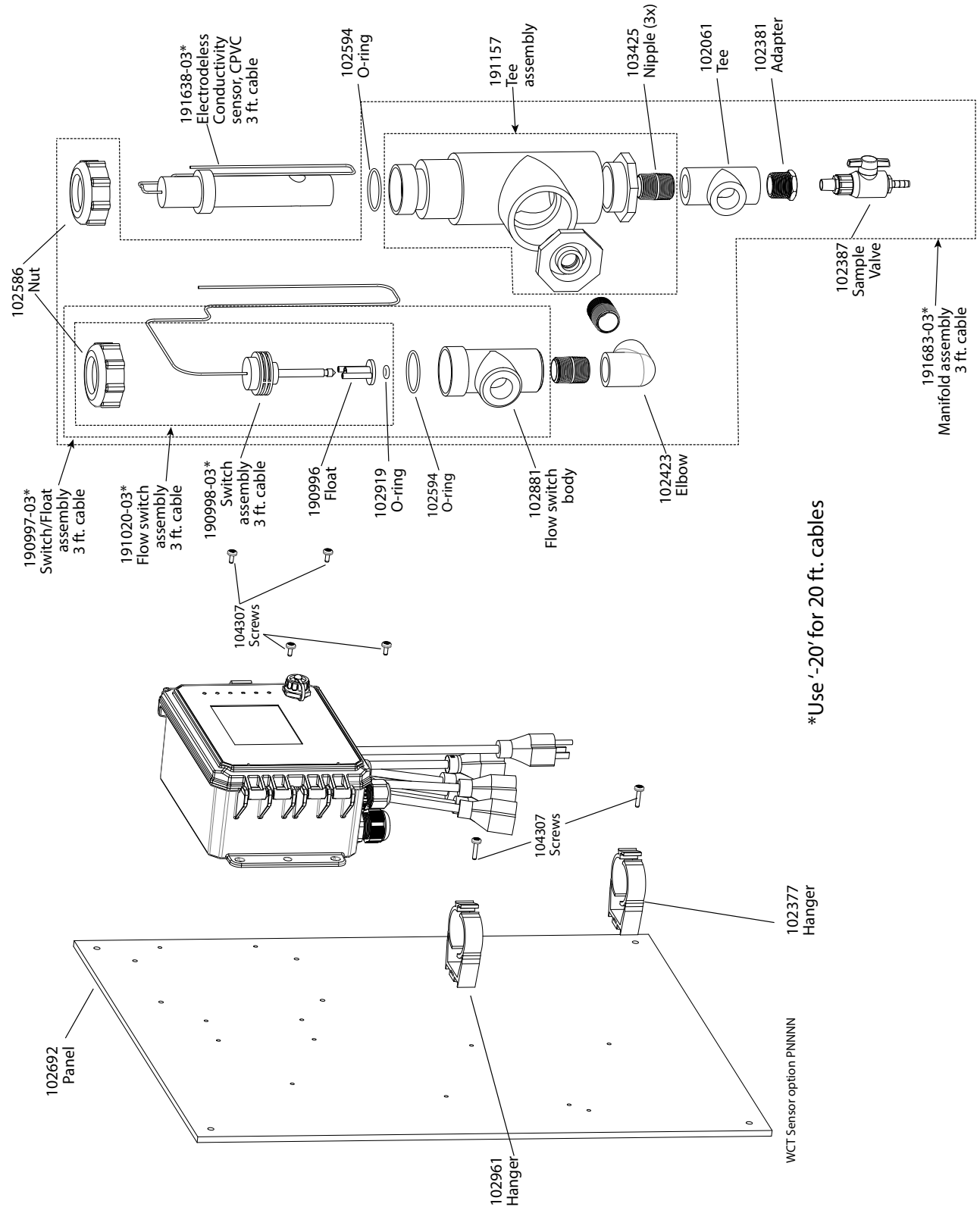

WCT Sensor Option PCNNN

PCNNN: Electrodeless conductivity + Flow Switch manifold on panel

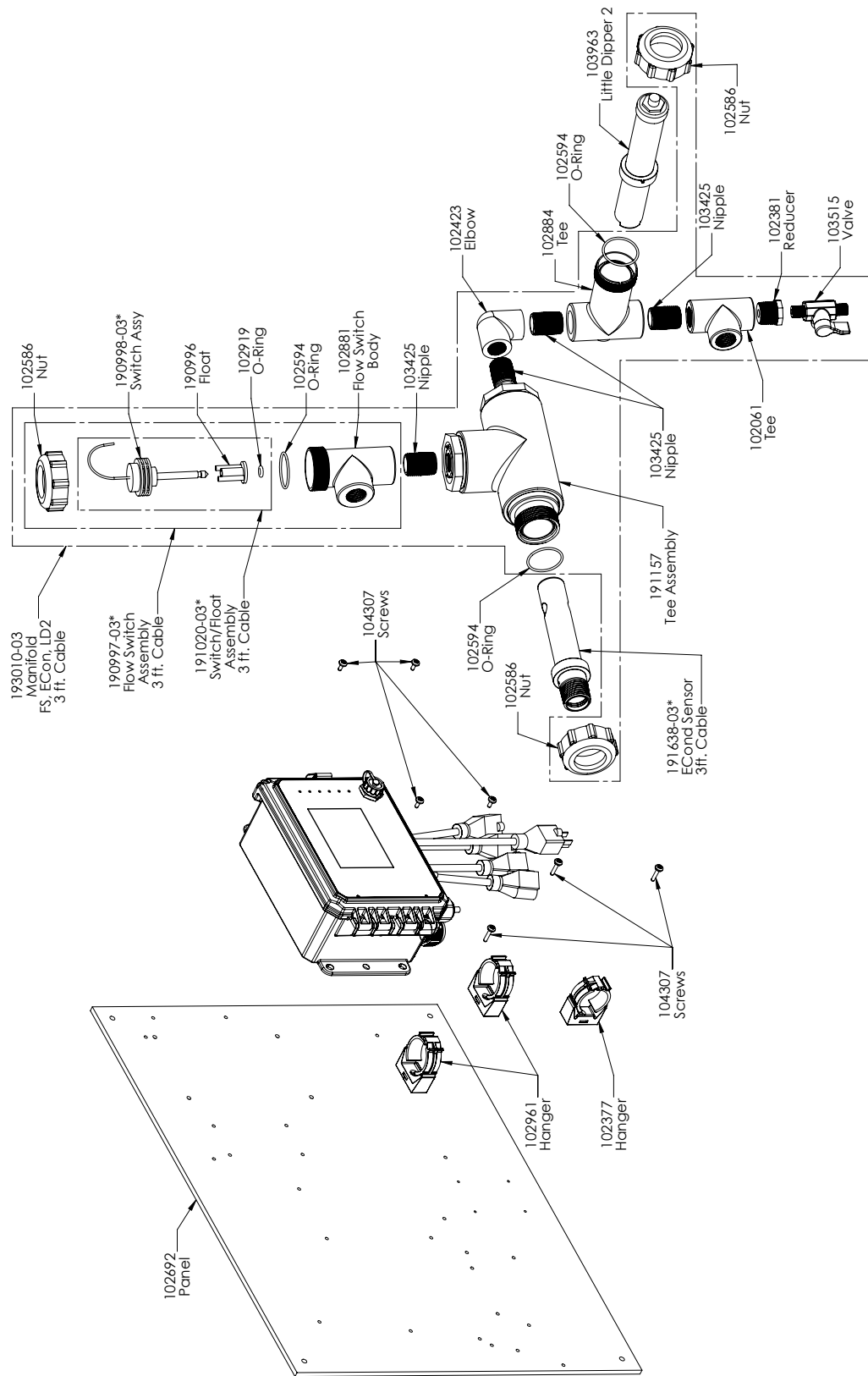

WCT Sensor Option PCMN

PCMN: Electrodeless conductivity + Flow Switch manifold on panel + LD

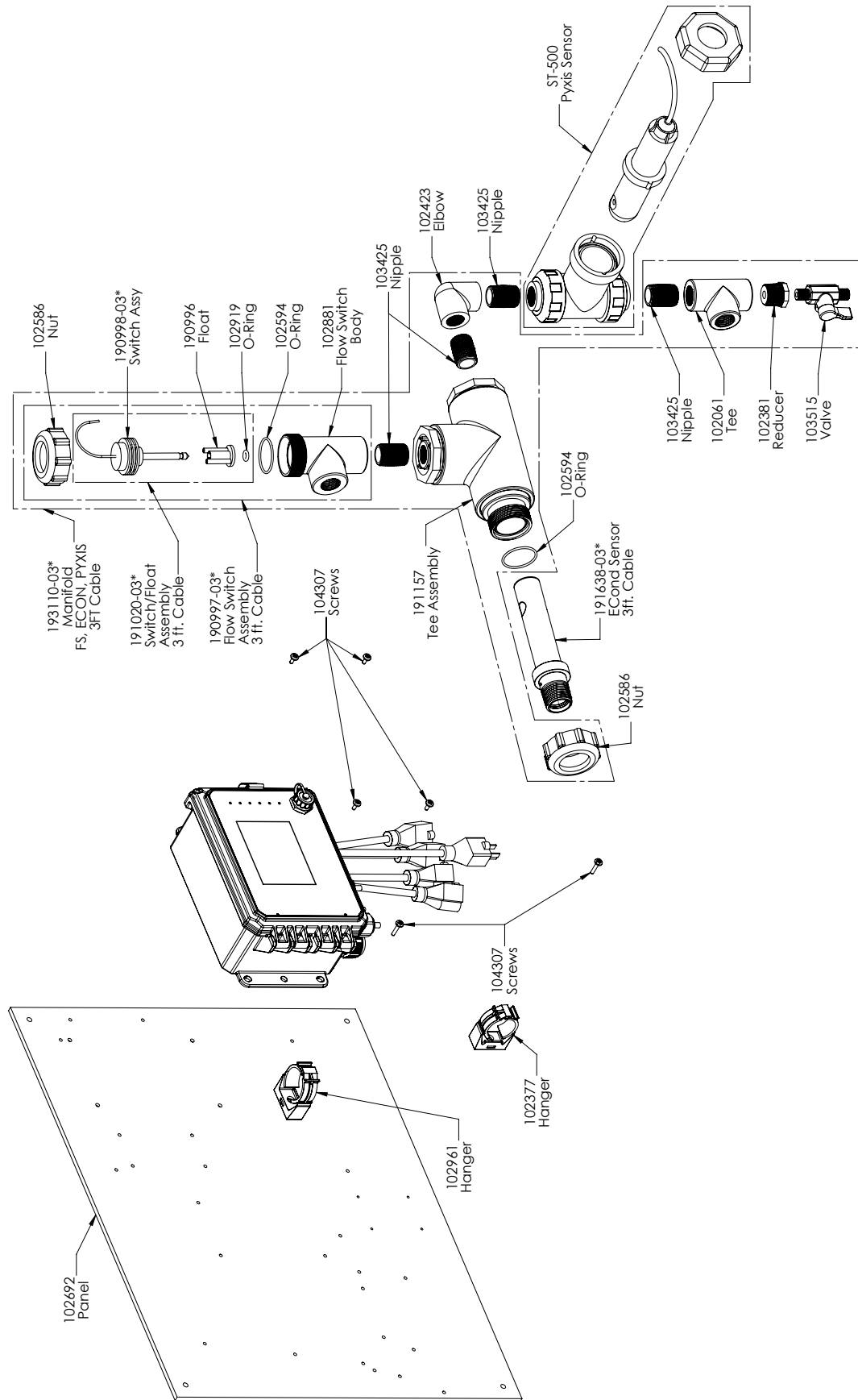

WCT Sensor Option PCPNN

PCPNN: Electrodeless conductivity + Flow Switch manifold on panel + Pyxis

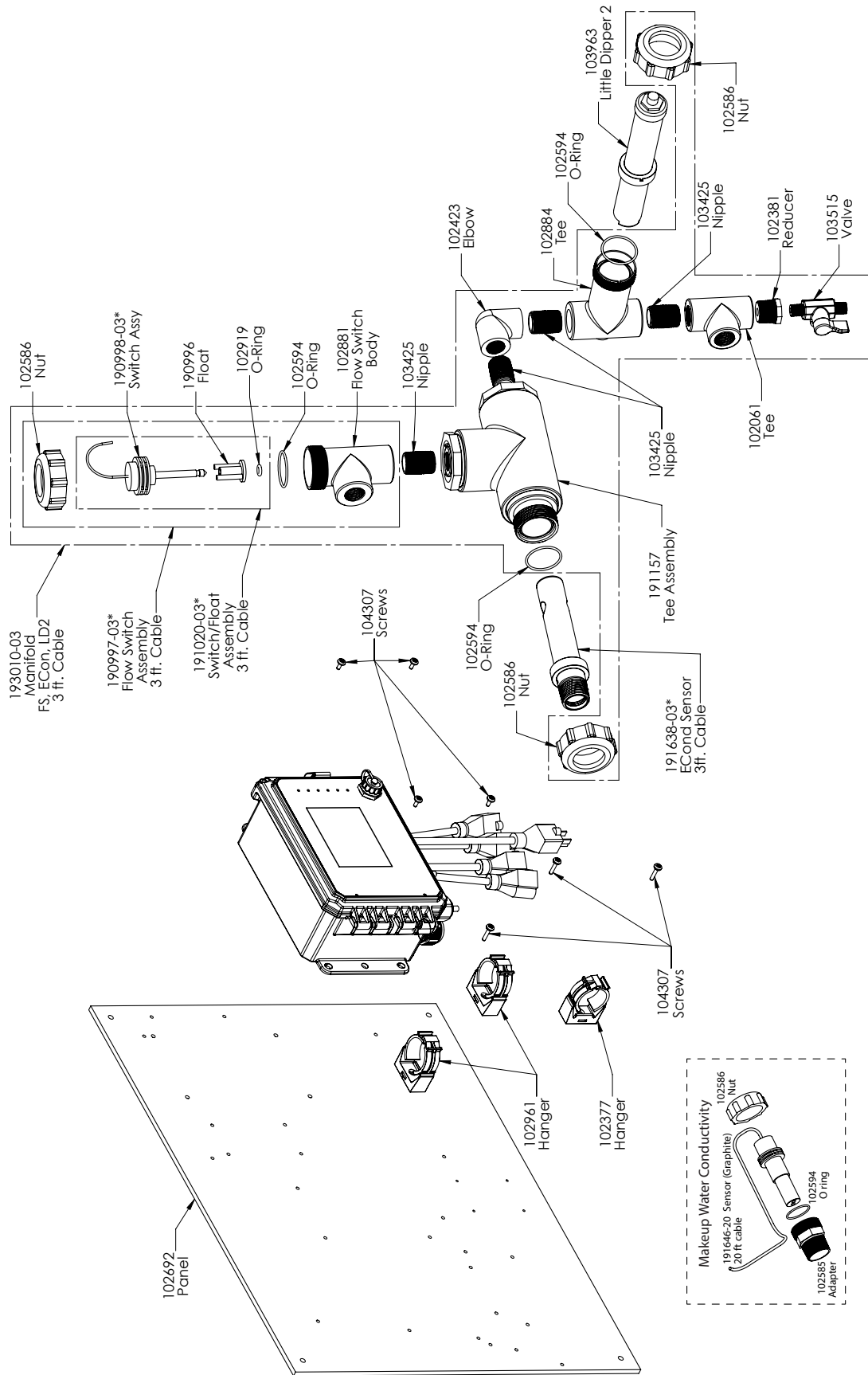

WCT Sensor Option PCEPN

PCEPN: Electrodeless conductivity + Pyxis + Flow Switch manifold on panel with Makeup graphite conductivity with threaded adapter

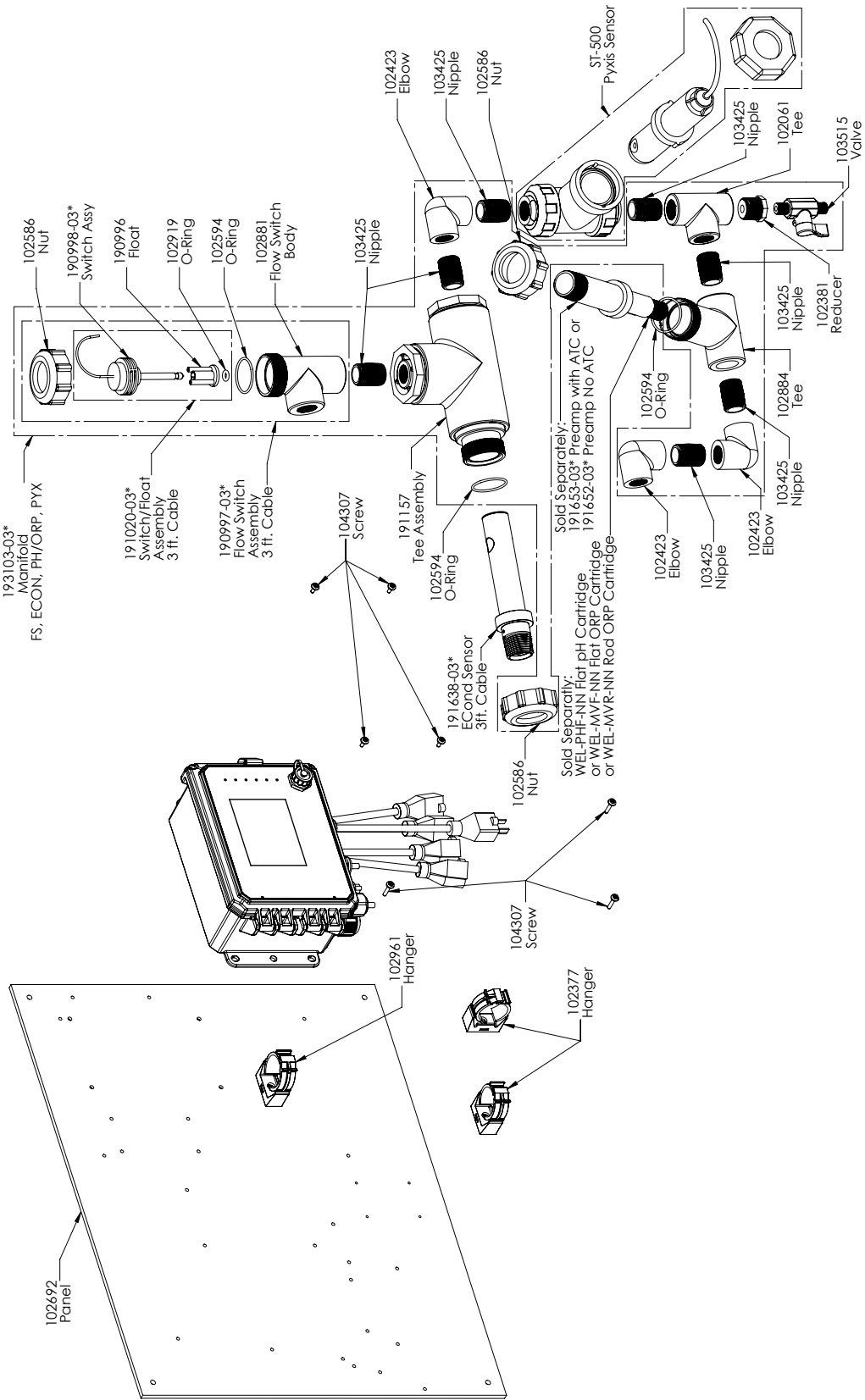

WCT Sensor Option PCFPN, PCHPN, PCIPN

PCFPN: Electrodeless conductivity + Flow Switch manifold on panel + WEL-PHF no ATC + Pyxis

PCHPN: + WEL-MVR no ATC + Pyxis

PCIPN: + WEL-MVF no ATC + Pyxis

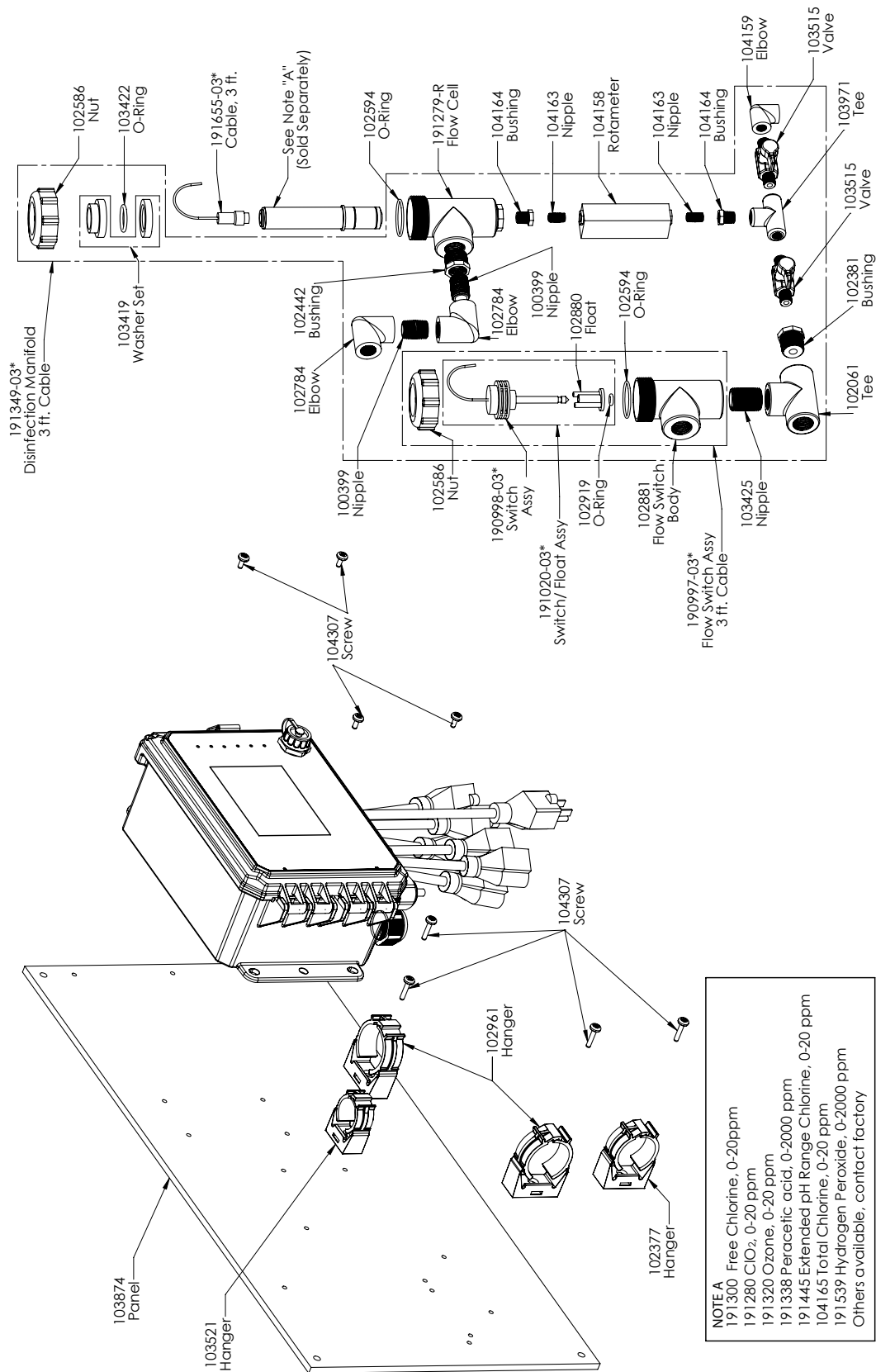

WDS Sensor Option PNNNN

PNNNN: Single DIS manifold on panel (Order disinfection sensor(s) separately)

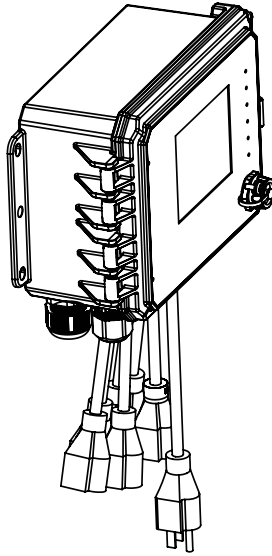

NOTE A (Sold separately)

- 191300 Free Chlorine, 0-20 ppm
- 191280 ClO₂, 0-20 ppm
- 191320 Ozone, 0-20 ppm
- 191338 Peracetic acid, 0-2000 ppm
- 191445 Extended pH Range Chlorine, 0-20 ppm
- 104165 Total Chlorine, 0-20 ppm
- 191539 Hydrogen Peroxide, 0-2000 ppm
- Others available, contact factory

* Use '-20' for 20 ft. cables

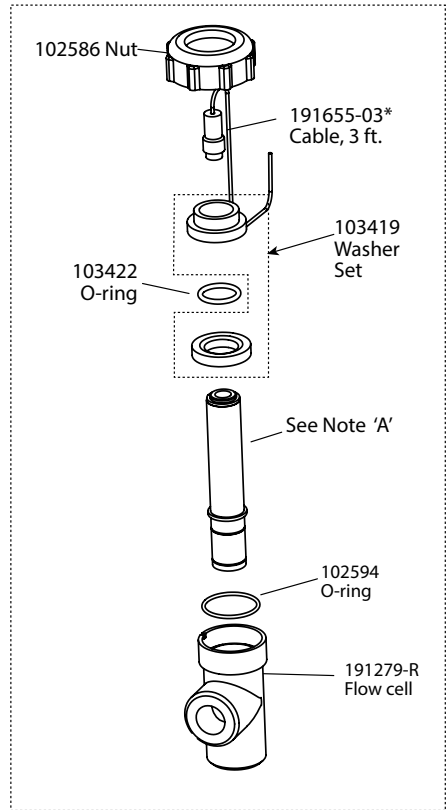

-INNNN has one

WDS Sensor option INNNN

WDS Sensor Option INNNN

INNNN: Single DIS flow cell/cable, no sensor (Order disinfection sensor(s) separately)

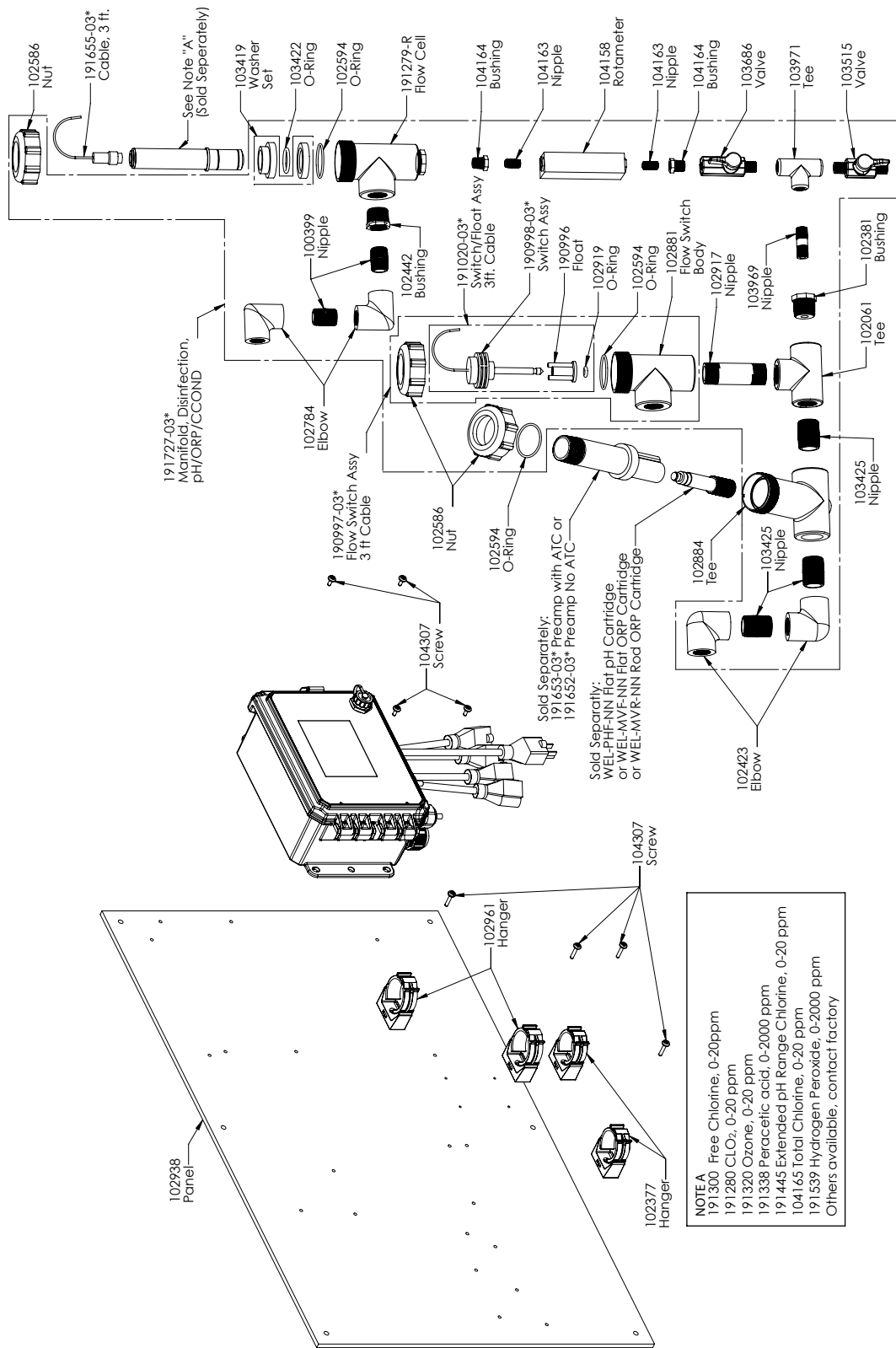

WDS Sensor Option PXNNN

PXNNN: DIS manifold plus pH/ORP/cooling tower cond tee on panel
(Order disinfection sensor and WEL electrode and preamplifier housing or cooling tower conductivity sensor separately)

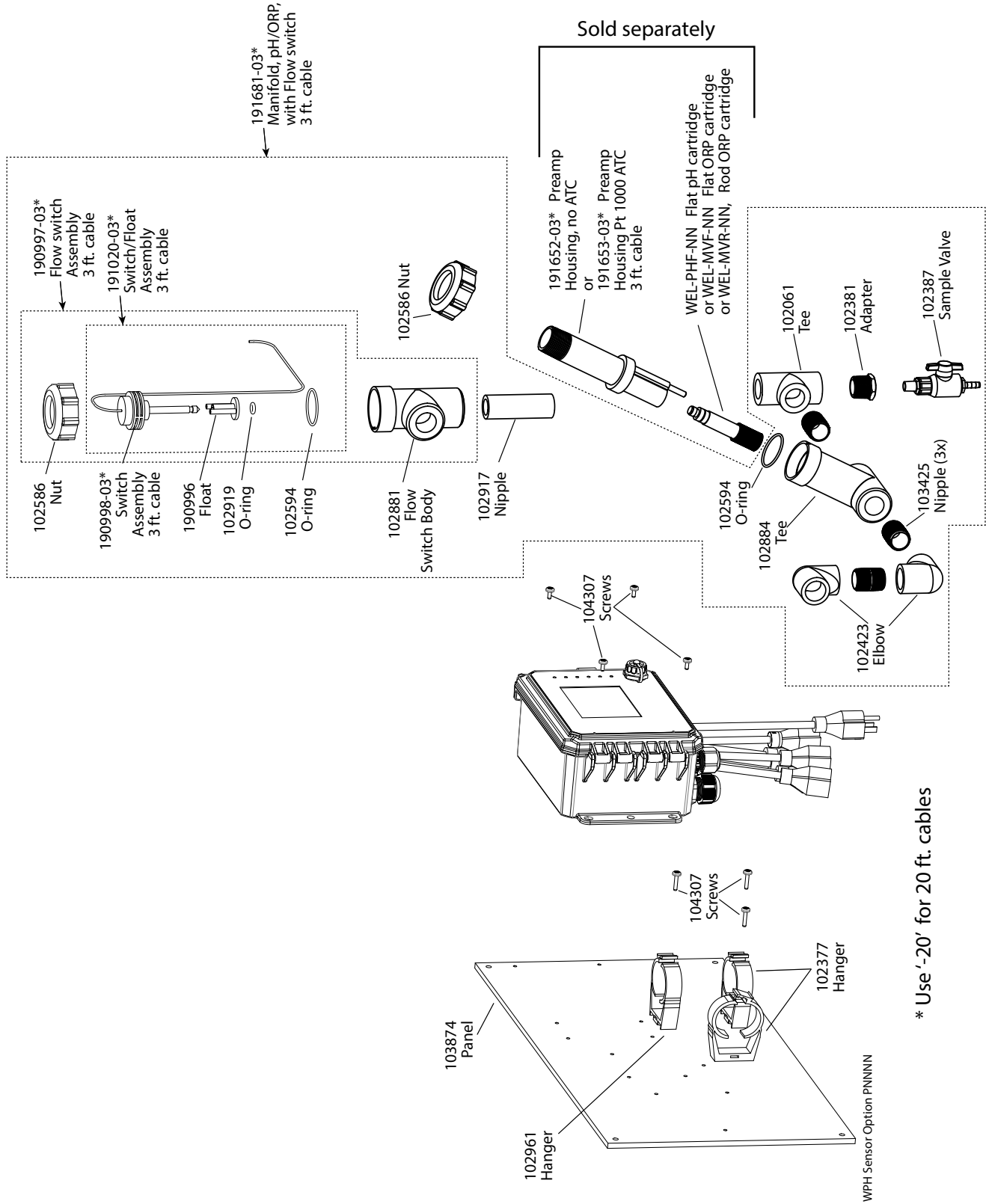

WPH Sensor Option PNNNN

PNNNN: Single low pressure manifold on panel (Order WEL electrode(s) and preamplifier housing(s) separately)

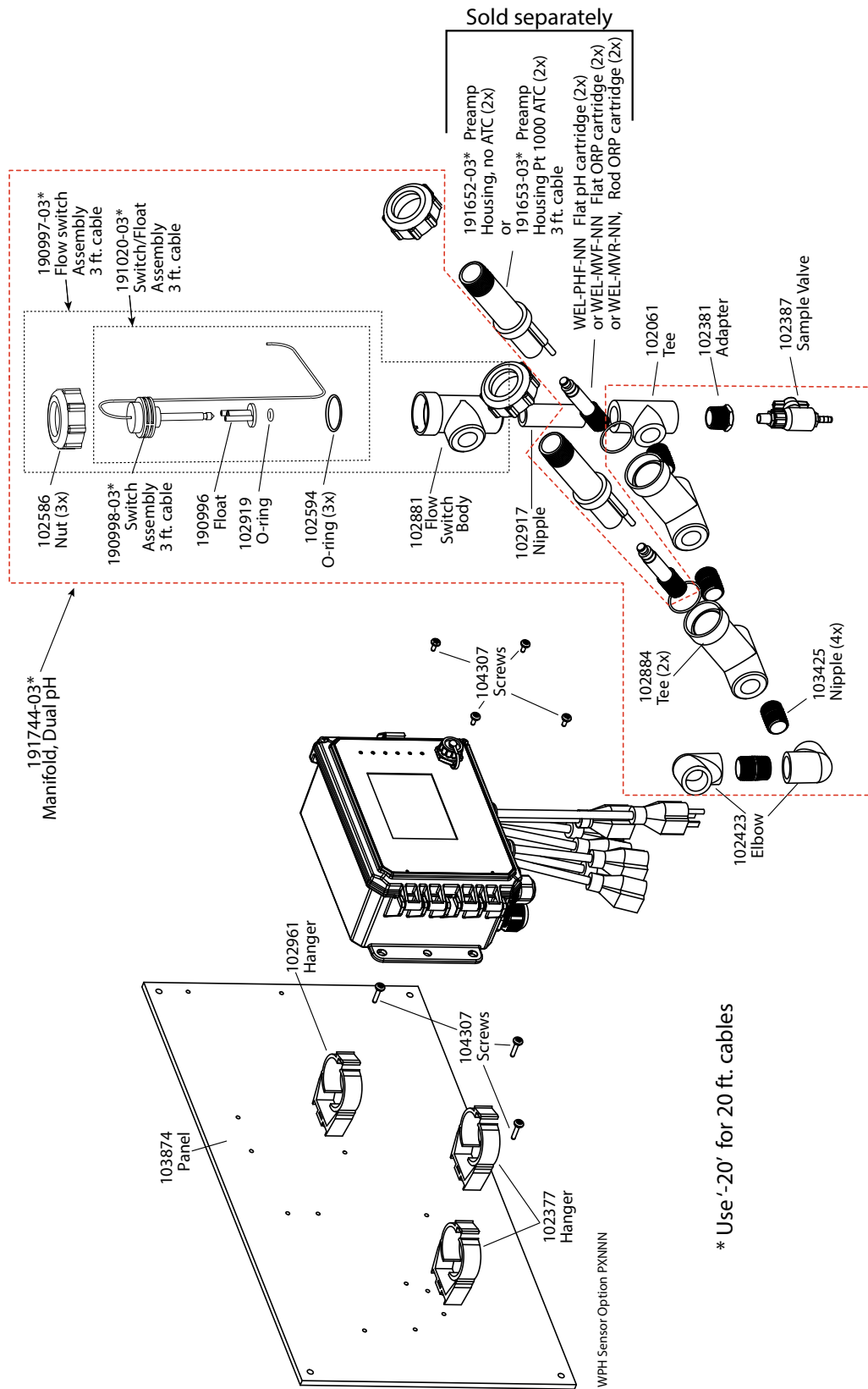

WPH Sensor Option PXNNN

PXNNN: Dual low pressure manifold on panel (Order WEL electrode(s) and preamplifier housing(s) separately)

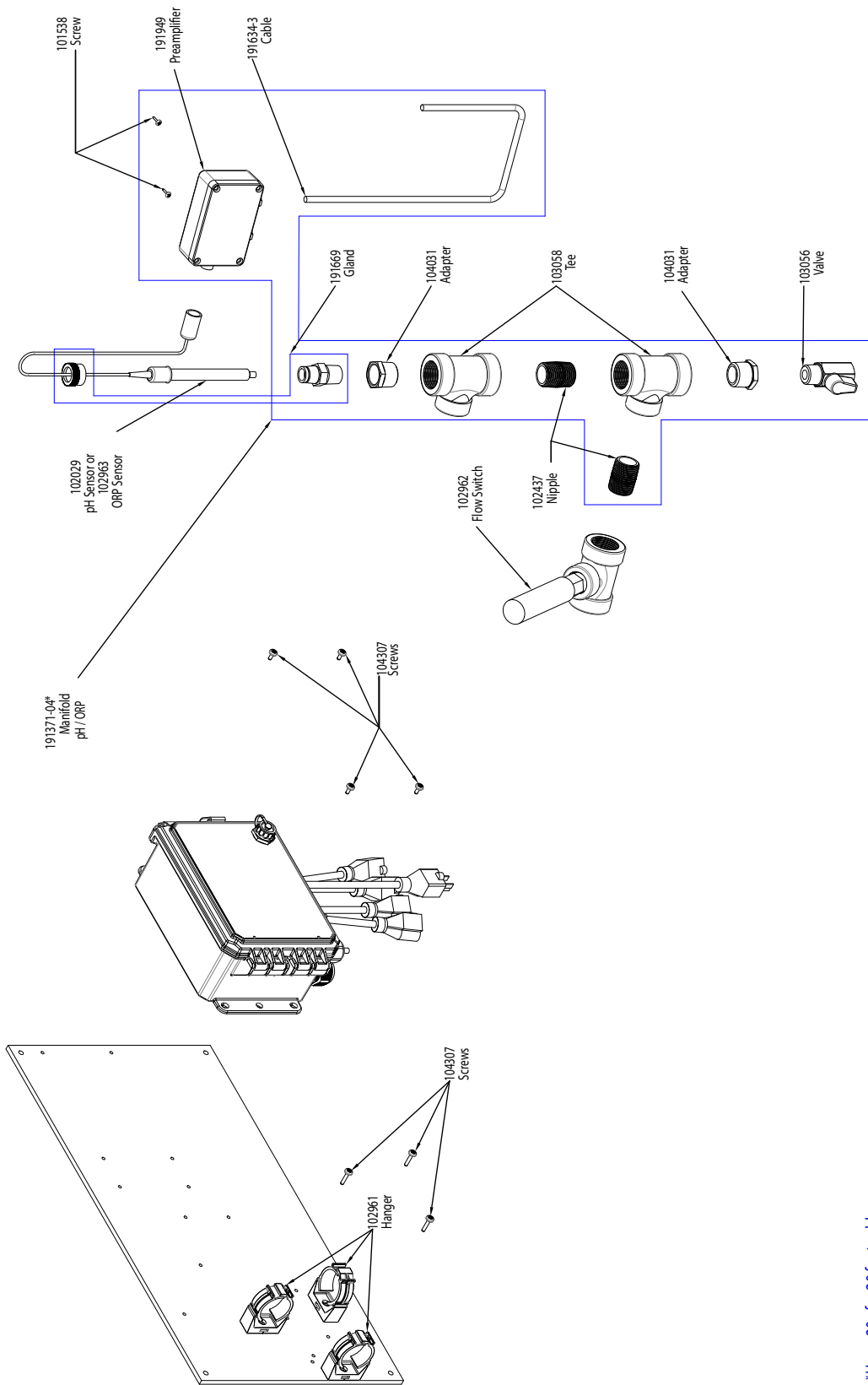

*Use -20 for 20 foot cables

WPH Sensor Option HANNN

HANNN: High pressure pH/ORP manifold plus 191949 preamplifier on panel
 (Order 102029 pH or 102963 ORP electrode separately)

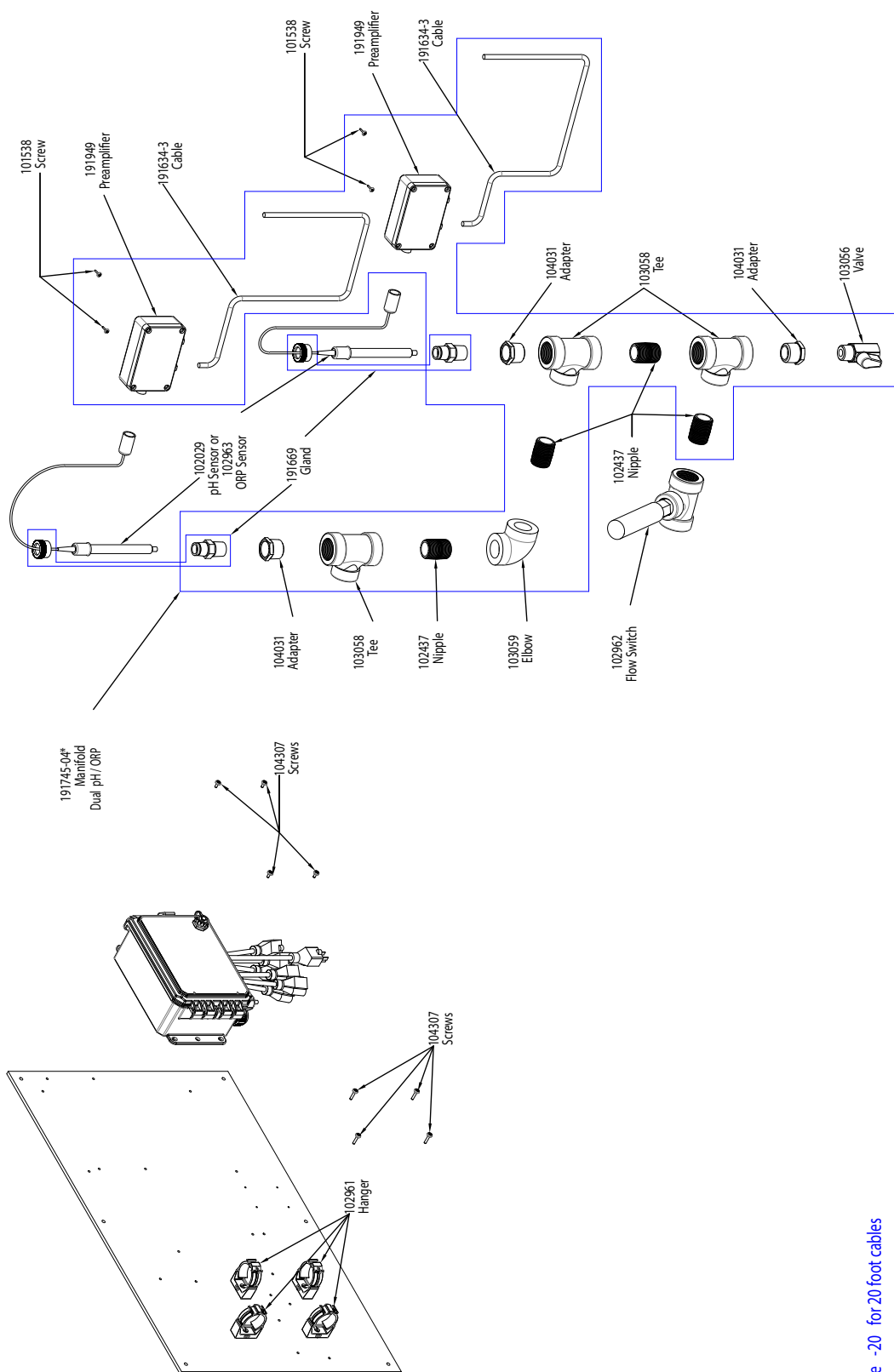

WPH Sensor Option HAANN

HAANN: Dual High pressure pH/ORP manifold plus two 191949 preamplifiers on panel
 (Order 102029 pH and/or 102963 ORP electrodes separately)

*Use -20 for 20 foot cables

SENSOR OPTION C

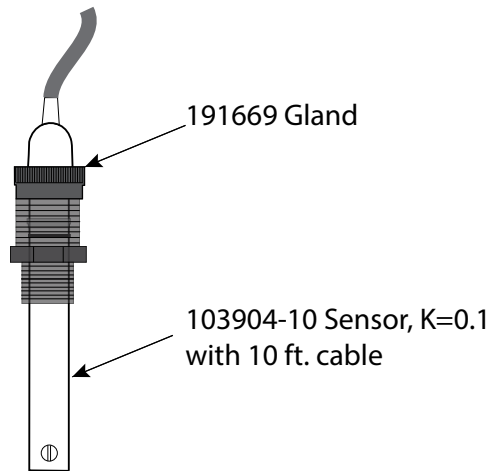

SENSOR OPTION A, B, D

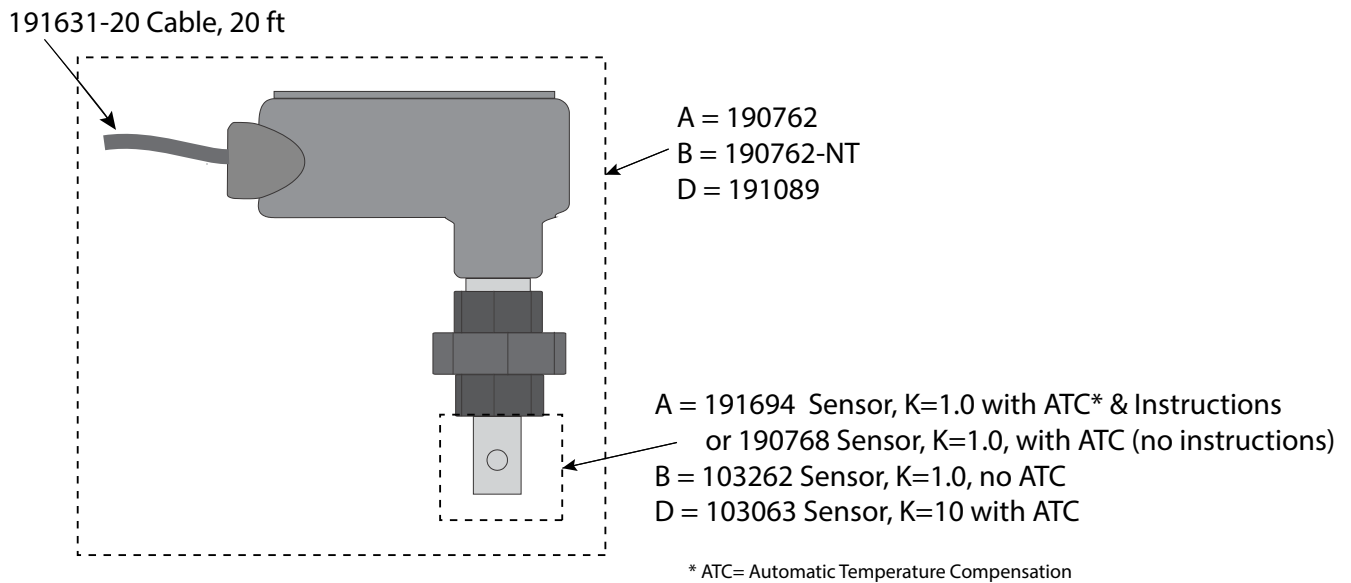

WBL Sensor options A,B,C,D

- A: Boiler sensor with ATC, 250 psi, 1.0 cell constant, 20 ft. cable
- B: Boiler sensor without ATC, 250 psi, 1.0 cell constant, 20 ft. cable
- C: Condensate sensor with ATC, 200 psi, 0.1 cell constant, 10 ft. cable
- D: Boiler sensor with ATC, 250 psi, 10 cell constant, 20 ft. cable