

3/8" Injection Check Valve High Pressure Spring Installation

For use with the PosiFlow Sensor. Provides the required 30PSI back pressure when there is little or no system pressure.

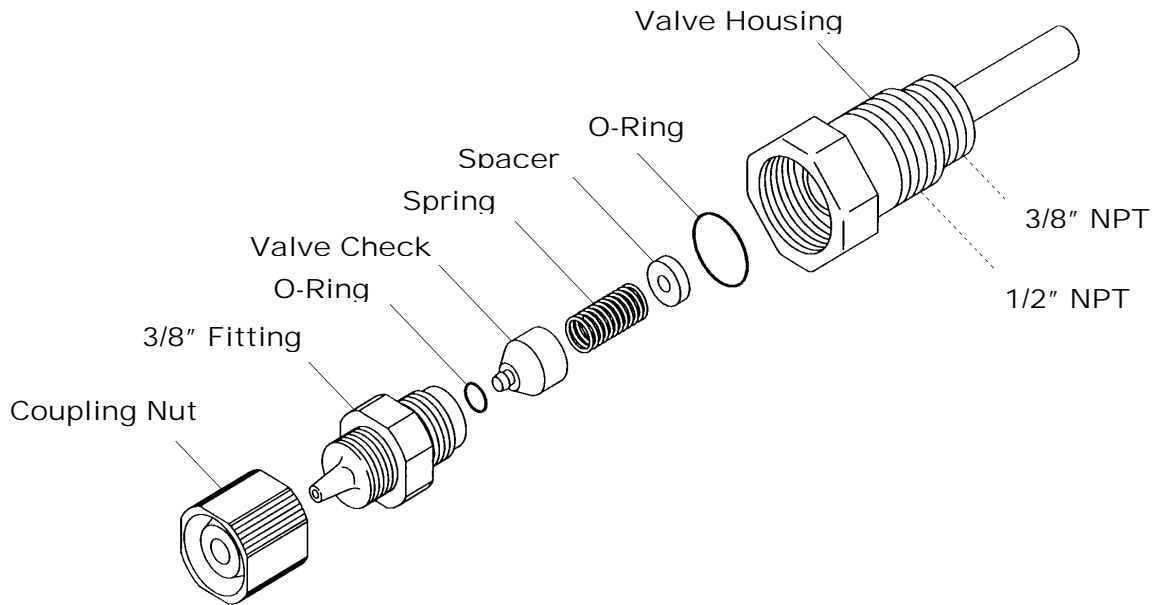

SPRING REPLACEMENT:

1. Unscrew the valve housing from the fitting.
2. Remove the existing spring and replace with the new high pressure spring (P/N E90375).
3. If there is a spacer behind the spring, make sure it also gets reinstalled.

CAUTION: Note orientation of the valve check/spring combination. The o-ring end of the valve check should go into the fitting and the spring should go toward the valve housing.

4. During reassembly, make sure that the o-ring between the valve housing and the fitting does not get pinched. Hand tightening these together should be sufficient, but using a wrench to get a snug fit may be necessary for sealing (1/8 turn max.).

Contact your local distributor with any questions about the installation of the high pressure spring into your 3/8" injection check valve.